

PMXs

PISTOL
USER MANUAL



CONTENTS

BASIC SAFETY RULES.....	4
CONTROLS AND COMPONENTS	10
AMMUNITION	12
DRY FIRING &“DUMMY” ROUNDS.....	13
LOADING AND FIRING	13
DESCRIPTION	21
SAFETY FEATURES.....	22
OPERATIONAL AND ERGONOMIC FEATURES	22
GENERAL OPERATION	24
LOAD CHECK	24
LOCKING THE BOLT TO THE REAR	25
SPECIFICATIONS	27
FIELD STRIPPING	28
REASSEMBLY	32
BARREL OBSTRUCTIONS CHECK	34
MAINTENANCE	35
BERETTA IRON SIGHTS.....	38
STORAGE	41
TROUBLESHOOTING	42

WARNING, CAUTION and Notice headings are defined as follows:

 **WARNING:**

The purpose of a **WARNING** is to draw attention to a potential dangerous situation that could result in personal injury.

 **CAUTION:**

A **CAUTION** concerns potential damage to firearm.

 **Notice:**

A **NOTICE** highlights important procedures and statements that require more emphasis than general text.

The references “left” or “right” always refer to the firearm as hold by the user.

The contents of this manual are subject to change without notice.

⚠ Notice: always keep this manual with your firearm. Include it with the pistol when it changes ownership or when it is loaned or presented to another person.

⚠ Notice: The Manufacturer and/or its Local Official Distributors assume no responsibility for product malfunction or for physical injury or property damage resulting in whole or in part from criminal or negligent use of the product, improper or careless handling, unauthorized modifications, use of defective, improper, hand-loaded, reloaded or remanufactured ammunition*, customer abuse or neglect of the product, or other influences beyond manufacturer's direct and immediate control.

* See paragraph "Ammunition".

⚠ WARNING: always ensure safety is engaged – if present until ready to fire. A safety, which is not fully engaged, will not prevent firearm discharge.

⚠ WARNING: ALL FIREARMS HAVE LETHAL POTENTIAL. READ THE BASIC SAFETY RULES CAREFULLY AND UNDERSTAND THEM FULLY BEFORE ATTEMPTING TO USE THIS FIREARM.

⚠ Notice: In addition to the Basic Safety Rules, there are other Safety Rules pertaining to the loading, unloading, disassembly, assembly and use of this firearm, located throughout this manual.

⚠ WARNING: READ THE ENTIRE MANUAL CAREFULLY BEFORE USING THIS FIREARM. MAKE SURE THAT ANY PERSON USING OR HAVING ACCESS TO THIS FIREARM READS AND UNDERSTANDS ALL OF THIS MANUAL PRIOR TO USE OR ACCESS.

⚠ Notice: we recommend the use of original Beretta spare parts and accessories. The use of other manufacturer's spare parts and accessories could cause malfunctions and/or breakages that will not be covered by the Beretta warranty.

BASIC SAFETY RULES

⚠ WARNING: PLEASE READ THIS MANUAL BEFORE HANDLING YOUR FIREARM.

⚠ WARNING: FIREARMS CAN BE DANGEROUS AND CAN POTENTIALLY CAUSE SERIOUS INJURY, DAMAGE TO PROPERTY OR DEATH, IF HANDLED IMPROPERLY. THE FOLLOWING SAFETY RULES ARE AN IMPORTANT REMINDER THAT FIREARM SAFETY IS YOUR RESPONSIBILITY.

1. NEVER POINT A FIREARM AT SOMETHING THAT IS NOT SAFE TO SHOOT.

Never let the muzzle of a firearm point at any part of your body or at another person. This is especially important when loading or unloading the firearm. When you are shooting at a target, know what is behind it. Some bullets can travel over a mile. If you miss your target or if the bullet penetrates the target, it is your responsibility to ensure that the shot does not cause unintended injury or damage.



2. ALWAYS TREAT A FIREARM AS IF IT WERE LOADED.

Never assume that a firearm is unloaded. The only certain way to ensure that a firearm has the

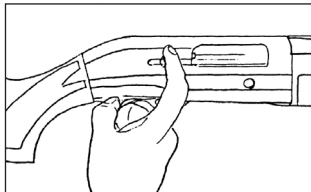
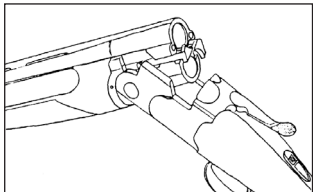
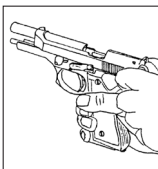

chamber(s) empty is to open the chamber and visually and physically examine the inside to see if a round is present. Removing or unloading the magazine will not guarantee that a firearm is unloaded or cannot fire. Firearms can be checked by cycling or removing all rounds and by then opening and inspecting the chamber so that a visual inspection of the chamber for any remaining rounds can be made.

3. STORE YOUR FIREARM SO THAT CHILDREN CANNOT GAIN ACCESS TO IT.

It is your responsibility to ensure that children under the age of 18 or other unauthorized persons do not gain access to your firearm. To reduce the risk of accidents involving children, unload your firearm, lock it and store the ammunition in a separate locked location. Please note that devices intended to prevent accidents - for example, cable locks, chamber plugs, etc, - may not prevent use or misuse of your firearm by a determined person. Firearm storage in a steel gun safe may be more appropriate to reduce the likelihood of intentional misuse of a firearm by an unauthorized child or person.

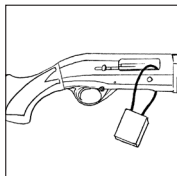
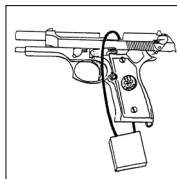

4. NEVER SHOOT AT WATER OR AT A HARD SURFACE.

Shooting at the surface of water or at a rock or other hard surface increases the chance of ricochets or fragmentation of the bullet or shot, which can result in the projectile striking an unintended or peripheral target.



5. KNOW THE SAFETY FEATURES OF THE FIREARM YOU ARE USING, BUT REMEMBER: SAFETY DEVICES ARE NOT A SUBSTITUTE FOR SAFE HANDLING PROCEDURES.

Never rely solely on a safety device to prevent an accident. It is imperative that you know and use the safety features of the particular firearm you are handling, but accidents can best be prevented by following the safe handling procedures described in these safety rules and elsewhere in the product manual. To further familiarize yourself with the proper use of this or other firearms, take a Firearms Safety Course taught by an expert in firearms use and safety procedures.

6. PROPERLY MAINTAIN YOUR FIREARM.

Store and carry your firearm so that dirt or lint does not accumulate in the working parts. Clean and oil your firearm, following the instructions provided in this manual, after each use to prevent corrosion, damage to the barrel or accumulation of impurities which can prevent use of the gun in an emergency. Always check the bore and chamber(s) prior to loading to ensure that they are clean and free from obstructions. Firing with an obstruction in the barrel or chamber can rupture the barrel and injure you or others nearby. In the event you hear an unusual noise when shooting, stop firing immediately, engage the manual safety and unload the firearm. Make sure the chamber and barrel are free from any obstruction, like a bullet blocked inside the barrel due to defective or improper ammunition.



7. USE PROPER AMMUNITION.

Only use factory-loaded, new ammunition manufactured to industry specifications: CIP (Europe and elsewhere), SAAMI® (U.S.A.). Be certain that each round you use is in the proper caliber or gauge and type for the particular firearm. The caliber or gauge of the firearm is clearly marked on the barrels of shotguns and on the slide or barrel of pistols. The use of reloaded or remanufactured ammunition can increase the likelihood of excessive cartridge pressures, case-head ruptures or other defects in the ammunition

that can cause damage to your firearm and injury to yourself or others nearby.

8. ALWAYS WEAR PROTECTIVE GLASSES AND EARPLUGS WHEN SHOOTING.

The chance that gas, gunpowder or metal fragments will blow back and injure a shooter who is firing a gun is rare, but the injury that can be sustained in such circumstances can be severe, including the possible loss of eyesight. A shooter must always wear impact resistant shooting glasses when firing any firearm. Earplugs or other high-quality hearing protectors help reduce the chance of hearing damage from shooting.



9. NEVER CLIMB A TREE, FENCE OR OBSTRUCTION WITH A LOADED FIREARM.

Open and empty the chamber(s) of your firearm and engage the manual safety before climbing or descending a tree or before climbing a fence or jumping over a ditch or other obstruction. Never pull or push a loaded firearm toward yourself or another person. Always unload a firearm, visually and physically check to see that the magazine, loading mechanism and chamber are unloaded, and action is open before handing it to another person. Never take a firearm from another person unless it is unloaded, visually and physically checked to confirm it is unloaded, and the action is open.



10. AVOID ALCOHOLIC BEVERAGES OR JUDGMENT/REFLEX IMPAIRING MEDICATION WHEN SHOOTING.

Do not drink and shoot. If you take medication that can impair motor reactions or judgment, do not handle a firearm while you are under the influence of the medication.



11. NEVER TRANSPORT A LOADED FIREARM.

Unload a firearm before putting it in a vehicle (chamber empty, magazine empty). Hunters and target shooters should load their firearm only at their destination, and only when they are ready to shoot. If you carry a firearm for self-protection, leaving the chamber unloaded can reduce the chance of an unintentional discharge.



12. LEAD WARNING.

Discharging firearms in poorly ventilated areas, cleaning firearms, or handling ammunition may result in exposure to lead and other substances known to cause birth defects, reproductive harm, and other serious physical injury. Have adequate ventilation at all times. Wash hands thoroughly after exposure.

⚠ WARNING: It is **YOUR** responsibility to know and abide by Federal, State and Local laws governing the sale, transportation and use of firearms in your area.

⚠ WARNING: This firearm has the capability of taking your life or the life of someone else! Always be extremely careful with your firearm. An accident is almost always the result of not following basic firearm safety rules.

ESPECIALLY FOR U.S. CONSUMERS:

For information about Firearm Safety Courses in your area, please visit the National Rifle Association's web site at www.nra.org.

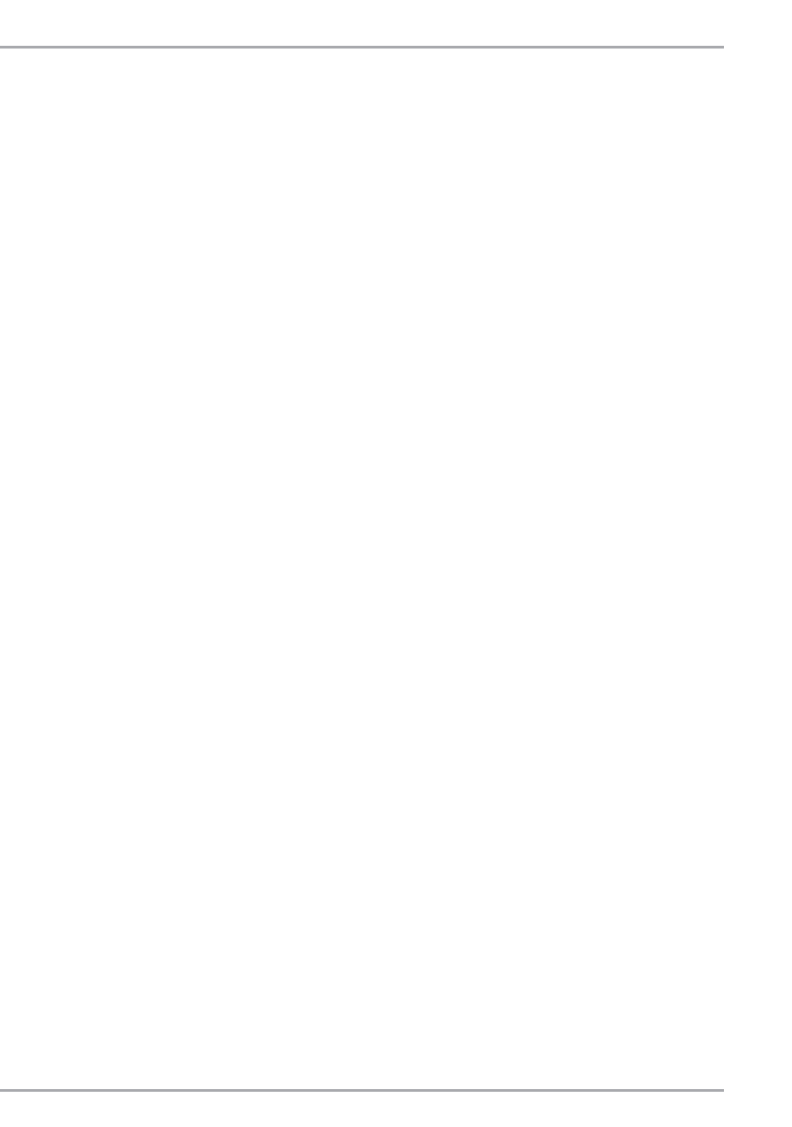

CONTROLS AND COMPONENTS

Notice: Iron Sights are optional to be purchased separately.

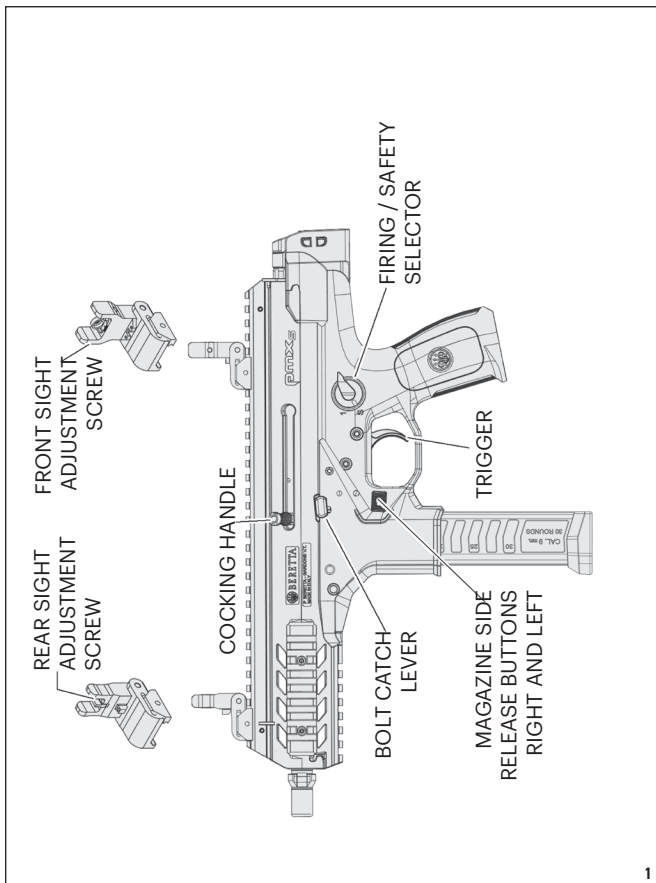

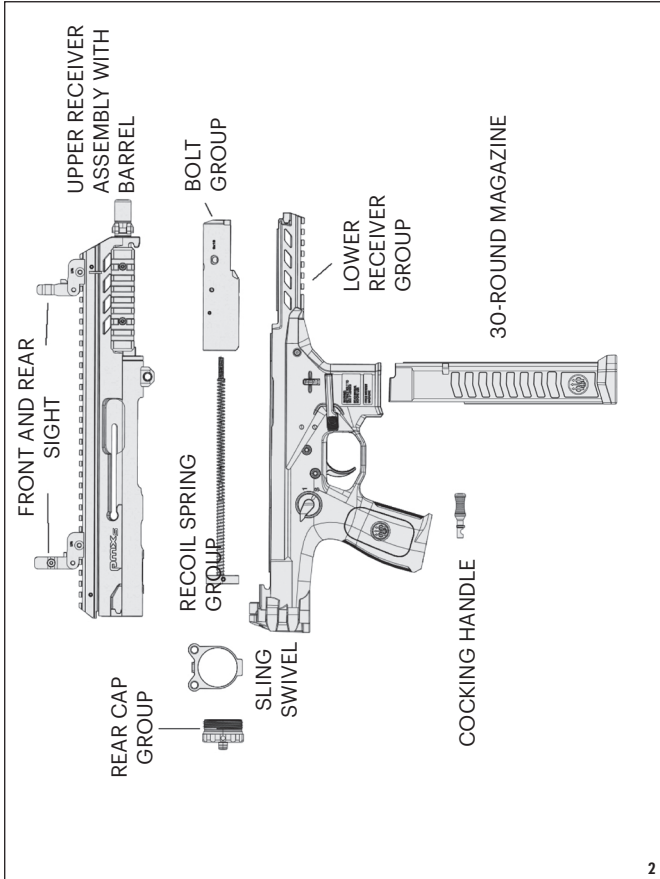

AMMUNITION

AMMUNITION (CARTRIDGE)

NOTICE: Beretta specifically disclaims responsibility for any damage or injury occurring with, or as the result of, the use of faulty, non-standard, “remanufactured,” hand-loaded or reloaded ammunition, or cartridges other than those for which the firearm was originally chambered. Serious damage or injury, even death, could result from the use of incorrect ammunition, from firing against bore obstructions and from propellant overloads. Use of improper ammunition, such as listed previously will void the manufacturer’s warranty. Use only high-quality, commercially-manufactured ammunition made in accordance with CIP (Europe and elsewhere) or SAA-MI® (USA) standards. Be certain that the ammunition is the appropriate caliber and loading for the firearm and is clean, dry and in good condition. The pistol caliber is stamped on the bolt, visible from the ejection port, and on the barrel.

⚠ WARNING: Carefully inspect each cartridge before it is loaded in the magazine. Be certain the cartridge cases are not split or deformed, and that the cartridges do not possess any other dents or defects. This warning even applies to factory ammunition.

Do not fire old ammunition. Primers, powder, cartridge cases, and bullets can deteriorate with time and cause damage to the firearm, or injury to the shooter or others.

⚠ WARNING: The extended use of +P or +P+ ammunition may decrease component part service life expectancy. **DO NOT** use sub-machine gun ammunition because the chamber pressure may reach or exceed proof load pressure. Lead bullets have a tendency to cause bore leading, which may dramatically increase the discharge pressure. Be sure to remove all chamber and bore lead accumulation after each use. **DO NOT** shoot cartridges with jacketed bullets through a barrel previously fired with lead bullets before the bore is thoroughly delead.

DRY FIRING & “DUMMY” ROUNDS

Dry firing is defined as firing a firearm with no ammunition in the chamber. Long term dry firing your Beretta PMXs pistol may result in damage to the striker. “Snap Caps” (inert chamber inserts that allow a firearm to be dry-fired without damaging the action) are available at most gun stores for those who wish to practice firing without live ammunition.

 **CAUTION:** “Dummy Rounds” with empty primer pockets are suitable for loading/unloading practice but **DO NOT PROTECT** the striker tip during dry firing.

LOADING AND FIRING

 **WARNING:** Whenever a live round is in the chamber, this pistol can fire, even if the magazine is empty or has been removed, unless equipped with a magazine disconnect safety.

 **WARNING:** Before loading the firearm, become familiar with the following loading procedures without the use of ammunition. Never handle a loaded firearm until you are familiar with the loading procedures.

 **WARNING:** Always keep your finger away from the trigger until you are prepared to fire.

 **WARNING:** LOAD THE CHAMBER ONLY WHEN READY TO FIRE.

LOADING THE MAGAZINE

⚠ WARNING: Be sure that you have the correct cartridges for your pistol.

To load the magazine:
Remove it from the pistol by depressing the magazine release button.

Hold the magazine in one hand. With the other hand, place a cartridge on the magazine follower in front of the feed lips at the top of the magazine. Press the cartridge down onto the follower and bolt the cartridge under the feed lips until it is seated fully inside the magazine body.

Repeat process until magazine is fully loaded. The translucent magazine allows for visual counting of cartridges.

ⓘ Notice: Magazine speed loader is optional to be purchased separately.

As an alternative you can use the speed loader to load the magazine.

⚠ CAUTION: Do not try to force more than the maximum number of rounds indicated for your particular pistol into the magazine. An overloaded magazine may not function properly.

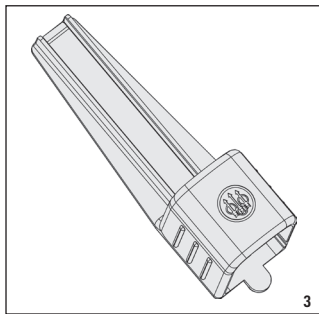
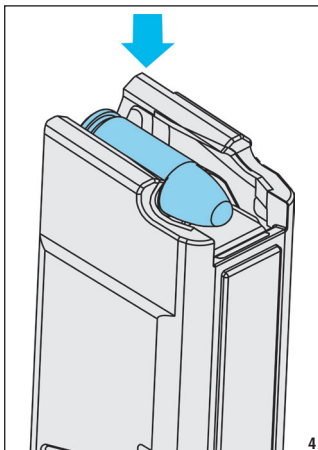

LOADING THE PISTOL AND THE FIRING CHAMBER

⚠ WARNING: Beretta assumes no responsibility for any injury or property damage resulting from improper or careless handling, intentional or accidental discharge of the firearm.

⚠ WARNING: Be sure that the obstruction check has been completed prior to loading.

⚠ WARNING: Point the firearm in a safe direction. Do not touch the trigger until you are ready to fire and are sure of your target and backstop.

The firing chamber is the portion of the barrel into which the cartridge is fed. The firing chamber may be loaded in one of two ways:

1. MANUALLY LOADING FROM MAGAZINE

Engage the manual safety by rotating the firing selector on the position S.

ⓘ Notice: if the hammer is un-cocked, the manual safety cannot be engaged.

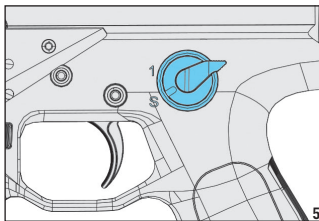

Completely push the loaded magazine into the magazine well to insure magazine housing engagement.

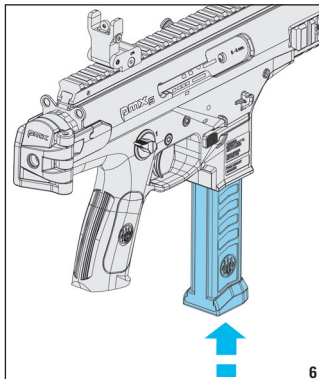

Pull back the bolt handle and release it. The bolt will automatically pick up a cartridge from the top of the magazine and feed it into the chamber.

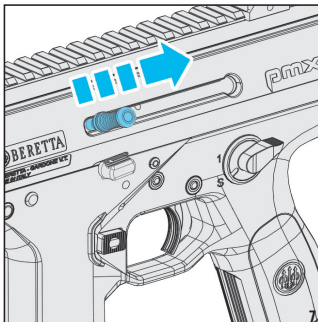

2. AS LONG AS THERE IS AMMUNITION IN THE MAGAZINE, A PISTOL WHICH IS LOADED AND FIRED, WILL AUTOMATICALLY PICK UP THE NEXT ROUND AND FEED IT INTO THE FIRING CHAMBER.

To replace a round of a magazine which has been chambered from the magazine; (remember that you are handling a loaded firearm with a live round in the chamber):

Check that the manual safety is engaged.

Make sure your finger is not on the trigger or inside the trigger guard.

Remove the magazine from the pistol by depressing the magazine release button.

Insert one more cartridge into the magazine.

Completely push the loaded magazine into the magazine well to insure magazine housing engagement.

⚠ WARNING: THE FIREARM YOU ARE HANDLING AT THIS POINT IS LOADED WITH A LIVE ROUND IN THE CHAMBER. Keep your finger away from the trigger whenever you do not intend to fire.

UNLOADING

⚠ WARNING: Always unload the firearm whenever you do not intend to shoot.

⚠ WARNING: Be certain the pistol is pointed in a **SAFE** direction. Keep your finger away from the trigger.

Engage the manual safety.

Keeping the firearm pointed in a safe direction and fingers away from the trigger, remove the loaded magazine from the frame.

Always using safety precautions fully retract the cocking handle to remove the chambered cartridge.

⚠ WARNING: Always visually inspect the firing chamber to ensure that it is empty. The chamber is empty when no cartridge is visible when looking from the ejection port into the open chamber.

⚠ WARNING: If you are ejecting unfired cartridges, use extreme care to be sure they are ejected onto an appro-

priate surface. Never attempt to housing cartridges or fired cartridge cases as they fall.

⚠ WARNING: Never allow anything to come in contact with the primer of unfired ammunition. Doing so could cause the ammunition to explode.

With the bolt locked open, make sure that you visually and physically inspect the chamber to ensure that it is empty.

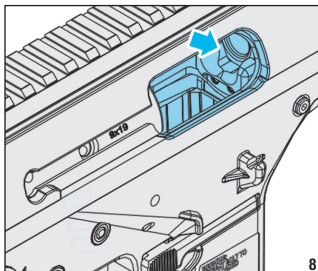

⚠ WARNING: Releasing the fully retracted bolt when a loaded magazine is in the pistol will feed a cartridge into the pistol's firing chamber and the pistol will be able to fire immediately.

⚠ Notice: It is recommended to store the firearm unloaded, bolt closed, with the magazine empty.

⚠ Notice: To increase the service life of the hammer spring, it is advisable to decock the hammer by rotating the fire selector to 1 and pulling the trigger.

UNLOADING THE MAGAZINE

To unload the magazine:

Grasp the magazine with one hand around the magazine box, bottom down and front end forward.

With the tip of the thumb firmly press down on the cartridge rim and push towards the front of magazine box.

As the cartridge moves forward, tip it slightly upward with the index finger.

Repeat until the magazine is unloaded.

FIRING

⚠ WARNING: Beretta assumes no responsibility for any injury or property damage resulting from improper or careless handling, intentional or accidental discharge of the firearm.

⚠ WARNING: Be certain the firearm is pointed in a **SAFE** direction. Never put your finger on the trigger unless you intend to shoot.

⚠ WARNING: High-quality eye and ear protection should be worn by all present when firing any firearm.

To fire the pistol, insert the magazine into the pistol and load a round into the chamber.

Rotate the firing selector to 1.

Without placing the finger on the trigger or inside the trigger guard, point the pistol at the intended target. Aim the pistol by aligning the front post in the aperture of the rear sight. Point the front post in the center of the target. The front post should be in focus, the target and the rear aperture slightly

blurred or out of focus.

⚠ WARNING: THE PISTOL IS NOW READY TO FIRE.

WHEN YOU ARE READY TO FIRE:

Place your index finger inside the trigger guard.

⚠ WARNING: Ensure that your hands are kept away from the muzzle of the barrel.

Gently squeeze the trigger, being careful not to upset the alignment of the front and rear sights. **THE PISTOL WILL FIRE.** The discharge will force the bolt to the rear, which will in turn eject the fired cartridge case, cock the hammer and compress the recoil spring. Then the bolt will close, feeding the next cartridge from the magazine into the chamber.

⚠ WARNING: THE PISTOL IS STILL LOADED, COCKED AND READY TO FIRE. Keep your finger away from the trigger whenever you do not intend to fire.

When the last round has been fired the bolt will remain open.

To fire again, remove the empty magazine and insert a loaded one.

Push the bolt catch lever down to load a cartridge into the chamber and shoot.

When you have completed shooting, remove the magazine, check that the firing chamber is empty, see "UNLOADING" on page 17 and close the bolt pushing the bolt catch lever again.

⚠ WARNING: Always unload the firearm immediately after shooting is completed. Never store a loaded firearm. To store the pistol see the paragraph "STORAGE" on page 41.

⚠ WARNING: If while firing the trigger is pulled and the firearm does not immediately fire: **CEASE FIRING IMMEDIATELY** and do the following:

A squib load is when a bullet is not fired with sufficient energy to leave the barrel and may create a dangerous obstruction. If a squib load has occurred

keep the firearm pointed in a safe direction.

With the pistol pointed in a SAFE direction, wait one (1) full minute.

After one (1) full minute has elapsed, completely unload the firearm by following the instructions in this manual "UNLOADING" on page 17.

Carefully inspect your ammunition. Immediately refer to a qualified gunsmith if the firing pin indent on a fired cartridge's primer is light, off-center or does not exist. Following the instructions "FIELD STRIPPING" on page 28, field strip the pistol and look down the barrel to make sure that no obstruction exists. If a barrel obstruction is detected, a qualified gunsmith must remove the obstruction and inspect the pistol before it can be fired.

⚠ WARNING: If another cartridge is fired into an obstructed barrel, catastrophic failure can result.

⚠ WARNING: If, while firing, you hear a change in the sound of a fired cartridge, or feel a change in the amount of recoil, or detect any other irregularity, **CEASE FIRING IMMEDIATELY and do the following:**

Keep the firearm pointed in a SAFE direction. A “squib load” may have occurred. A “squib” occurs when a cartridge fires, but with insufficient force to drive the bullet out of the barrel. This can result in a dangerous bore obstruction.

With the gun pointed in a SAFE direction, completely unload the firearm by following the “UNLOADING” on page 17. Following the instructions “FIELD STRIPPING” on page 28, field strip the pistol and look down the barrel to make sure that no obstruction exists.

⚠ WARNING: Never attempt to reuse or fire ammunition that did not fire the first time. Dispose of unfired or damaged ammunition properly, per the ammunition manufacturer’s recommendation.

DESCRIPTION

The Beretta PMXs pistol is a sporting or personal defense firearm with a particularly captivating appearance and simplicity of use. The blowback type locking system ensure reliability, great stability and precision in follow up shots.

The cold hammer forged barrel is made of high resistance steel for maximum resistance and increased barrel life.

The magazine is made from translucent polymer.

SAFETY FEATURES

Firing pin block

Beretta PMXs pistols have a striker blocking device that prevents forward movement of the striker in the event the pistol is dropped.

Manual safety

The Beretta PMXs pistol has a firing selector with two positions: S and 1.

When S is selected the weapon will not fire. The selector is available in both sides of the pistol and may be rotated by the thumb of the hand holding the pistol's handgrip.

 **Notice:** The position S cannot be selected when the hammer is not cocked.

OPERATIONAL AND ERGONOMIC FEATURES

Semiautomatic firing

Beretta PMXs pistols will automatically reload after each round is fired, as long as there are cartridges in the magazine.

The blowback operating system ensure reliability, great stability and precision in follow up shots. Single action. The short and light single action trigger pull allows for faster, more accurate discharge of subsequent rounds.

Magazine. The Beretta PMXs pistol has a quickly removable, high capacity magazine which allows rapid reloading and extended use in emergency situations.

Ambidextrous controls. Firing selector and magazine release button are available on both right and left side of the pistol.

Sling swivels: The pistol has four sling attachment rings: two next to the barrel muzzle,

two next to the rear part of the receiver. Furthermore there is a flush cup attachment in the middle of the rear cap of the upper receiver.

Reversible cocking handle. The cocking handle may be installed on both sides of the pistol, at your convenience. The reversion does not require any tools.

Bolt catch. The bolt catch is a lever that holds the bolt open after the last round is fired. This allows the user to immediately determine that the pistol does not have a round in the chamber or in the magazine.

Accessory rail.

- MIL-STD 1913 (STANAG 4694) metal accessory rail, available on the upper receiver at 12, 3, 9 o'clock:
 - metal rail with 32 slots at 12 o'clock as long as the receiver;
 - two metal rails with 8 slots at 3 o'clock and 9 o'clock;
- MIL-STD 1913 (STANAG 4694) polymer accessory rail with 7 slots at 6 o'clock, integrated with the lower receiver.

Sights

The PMXs pistol has flip-up iron sights adjustable for zeroing. Rear sight is adjustable in eleva-

tion and front sight is adjustable in windage. Sights are foldable for use with optics. In folded position, backup sights are integrated into the sights for readiness of use.

GENERAL OPERATION

When the trigger of the Beretta PMXs pistol is pulled, the hammer is released and, pushed by the spring after having lifted the safe lever on the firing pin, it turns and strikes the firing pin, which advances and strikes the primer of the ammunition. The primer detonates igniting the powder. The powder burns creating a gas that pushes the bullet down the barrel and the case back together with the bolt. The mass of the bolt allows for a delay in opening of the bolt to allow for the case to be correctly removed from the chamber.

Then the bolt continues to move backwards, ejecting the spent case through the ejection port and cocking the hammer. When the case has been ejected, the bolt is stopped and pushed forward once more by the recoil spring.

By moving forward, the bolt strips a round from the magazine and inserts it into the chamber returning to battery.

When the last round of the magazine is fired, the magazine follower engages the bolt catch and locks the bolt open.

LOAD CHECK

⚠ WARNING: Keep your finger **OFF OF THE TRIGGER** and the barrel pointed in a **SAFE direction** when checking to be certain your PMXs pistol is unloaded.

To visually check that your pistol is unloaded, carefully follow the steps below.

Remove the magazine by depressing the magazine release button.

Retract the bolt and visually inspect the cartridge chamber. The pistol is unloaded when no cartridge is visible when looking into the open chamber.

For safety, you should...

Always visually check to see that the chamber is unloaded.

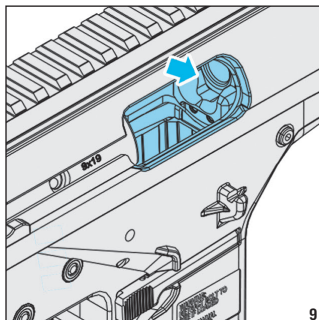

Never assume that a firearm is unloaded (even with a gun that is new and in its original packaging).

Never point a firearm toward yourself or another person.

Lock the bolt in the open position and remove the magazine before handing the pistol to another person.

Never take any pistol from another person unless the bolt has been locked open, the magazine has been removed and the chamber has been visually checked to confirm it is unloaded.

LOCKING THE BOLT TO THE REAR

⚠ WARNING: Keep your finger **OFF OF THE TRIGGER** and the barrel pointed in a **SAFE** direction.

⚠ WARNING: Always keep your finger away from the ejection port.

Locking the bolt in the open position can be accomplished in two ways.

1) insert an empty magazine into the pistol. Retract the bolt until the bolt locks in the open position.

The bolt will remain locked in

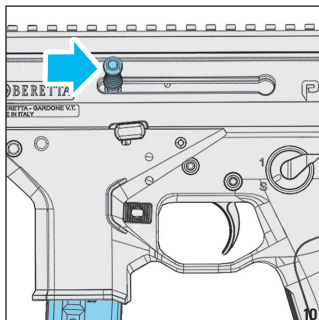

the open position when the magazine is removed.

⚠ Notice: The bolt will be released when pulled to the rear if a **LOADED** magazine is inserted.

⚠ Notice: The bolt will be released when pulled to the rear if **NO** magazine is inserted.

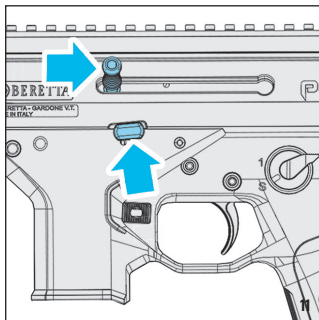

2) with no magazine in the pistol, retract the bolt while pressing up on the bolt catch to lock the bolt in the open position.

SPECIFICATIONS

Notice: Iron Sights are optional to be purchased separately.

FEATURE	VALUE
Caliber	9x19 mm Luger
Safety fetures	Manual, locks the trigger
	Firing pin block
Operating system	Blowback
Action	Single action only
Magazine	Translucent, lightweight and yet resistant, 30-round polymer magazine allows visual account of the cartridges inside 20-round capacity is available
BARREL	
Type of rifling	Clockwise
No. of grooves	6
Pitch	9.84 in / 250 mm
DIMENSIONS AND WEIGHT	
Maximum length	less than 16.93 in / 430 mm
Nominal barrel length	6.89 in / 175 mm
Height with magazine, without sights	~ 9.84 in / 250 mm
Height with magazine, with folded sights	~ 10.63 in / 270 mm
Width	~ 2.91 in / 74 mm
Line of sight	~ 9.84 in / 250 mm
Weight (without magazine)	~ 79.4 oz (4.96 lbs) / 2,25 kg
Weight (with empty magazine)	~ 82.9 oz (5.18 lbs) / 2,35 kg

FIELD STRIPPING

⚠ WARNING: Make sure the pistol is unloaded. If not, unload it following the instructions in this manual “UNLOADING” on page 17.

Remove the magazine and ensure the pistol is unloaded by inspecting the barrel's chamber.

To disassemble the pistol:

1. Retract the bolt to cock the hammer.
2. Position the fire selector to “S”.

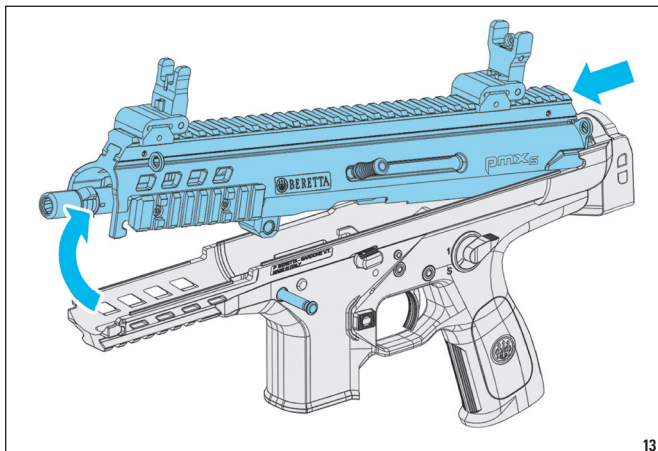
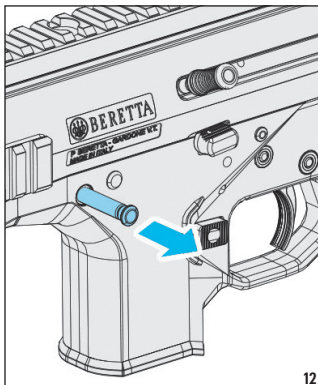

3. Press the captive disassembly pin moving it from right to left across the weapon as far as it can go. The catch will remain on the left side of the lower receiver.
4. Push the receiver forward.
5. Rotate the receiver upwards and remove it from the lower receiver.
6. Unscrew the rear cap and remove it.

8. Remove the recoil spring group from the receiver.

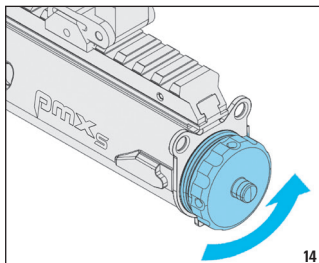

7. Remove the sling swivel.

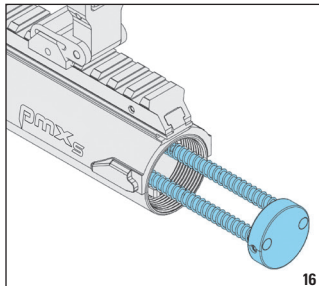
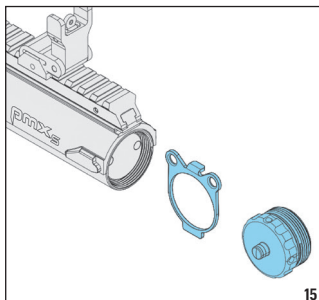

9. Align the cocking handle with the hole in the receiver and remove it by pulling it outwards.

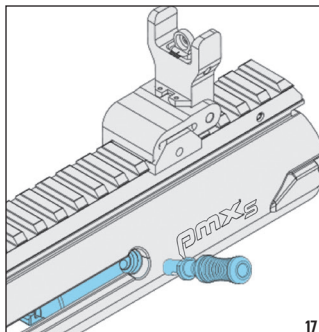

⚠ Notice: if the weapon is being disassembled to reverse the cocking handle, nothing further is required.

10. Remove the bolt.

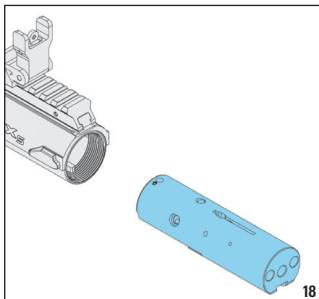

The weapon is now disassembled and ready for cleaning.

⚠ Notice: No further disassembly is required for routine maintenance and "BARREL OBSTRUCTIONS CHECK" on page 34.

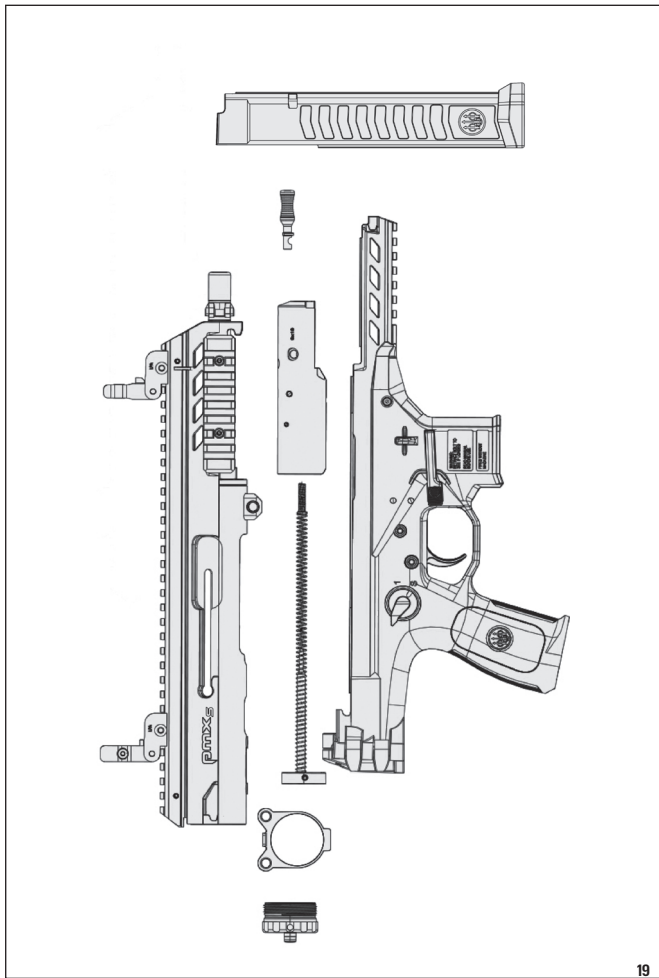

REASSEMBLY

To reassemble the weapon:

1. Insert the bolt into the upper receiver until the cocking handle seat has aligned with the recess in the upper receiver.
2. Fully insert the cocking handle, properly oriented, into the bolt. Retract the bolt to ensure that the bolt moves freely.

⚠ Notice: if the weapon is being reassembled to reverse

the cocking handle, assemble the cocking handle on the required side.

3. Insert the recoil spring group with the groove pointing down.

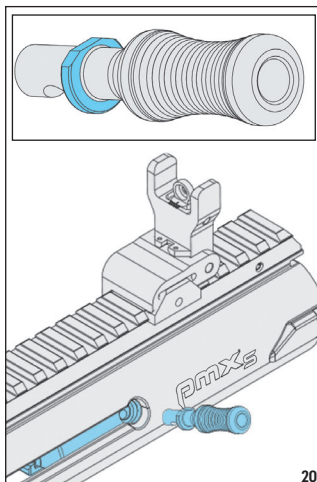
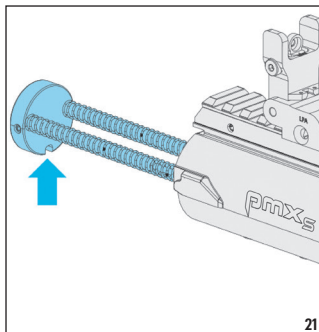

4. Insert the sling swivel properly oriented.

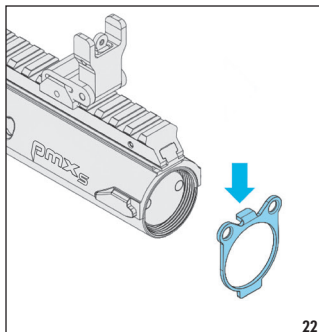

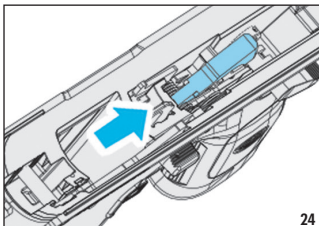
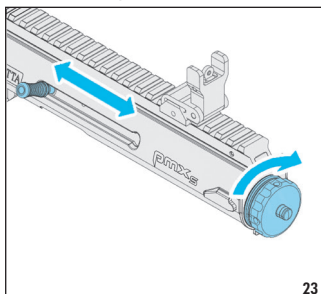

5. Screw on the rear cap until tight.
6. Retract the bolt twice and tighten the rear cap once again. Repeat until the rear cap is snug.
7. Cock the hammer with your finger.

⚠ Notice: check that the sling swivel does not move and is locked tight by the cap.

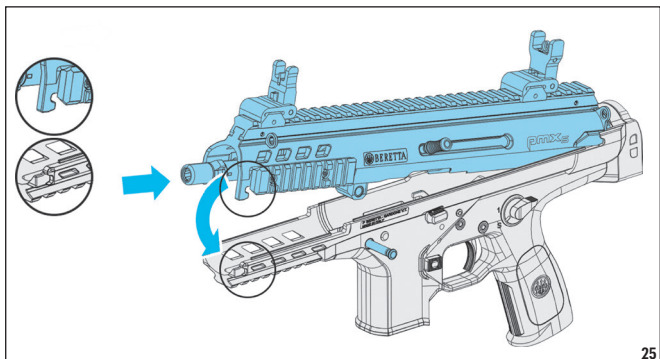

8. Position the fire selector to "S".
9. Insert the upper receiver into the lower receiver in the interlocking points.
10. Turn the upper receiver paying the utmost attention to interference between upper and lower front connection wings (see detail on FIG. 25).



 **CAUTION:** turning with interference between upper and lower front connection wings may damage the wings.

11. Then pull it back completely.
12. Insert the captive disassembly pin through the weapon.
13. Always retract the bolt twice to reset the trigger mechanism.

BARREL OBSTRUCTIONS CHECK

 **WARNING:** Catastrophic failure can result if a cartridge is fired into an obstructed barrel.

If you believe the barrel might be obstructed follow the “FIELD STRIPPING” operations and disassemble the pistol (page 28).

After disassembly, look down the barrel and check to be sure there are no obstructions in the chamber or bore.

If an obstruction in the barrel is detected, a qualified gunsmith **MUST** remove the obstruction and inspect the pistol to ensure it is safe before it can be fired.

If no obstruction is found, reassemble the pistol by following the procedures given in the “REASSEMBLY” section of this manual (page 32).

MAINTENANCE

The firearm should be cleaned as soon as possible after firing. Use only high-quality, commercially available firearm cleaning solvents, gun oil and cleaning equipment.

Field strip the pistol as indicated in the "FIELD STRIPPING" section of this manual (page 28).

⚠ WARNING: Excess oil and grease obstructing the bore, even partially, is very dangerous when firing and may cause barrel rupture and serious injury to the shooter and bystanders. Never spray or apply oil to the cartridges. Use lubricants properly. You are responsible for the proper care and maintenance of your firearm.

⚠ CAUTION: do not use abrasive materials, such as sandpaper or abrasive pastes, to clean the weapon.

BERETTA CLEANING KIT

ⓘ Notice: Cleaning kit is optional to be purchased separately.

The cleaning kit includes:

- 1) Plastic bag;
- 2) Cloth brush;
- 3) Metal brush
- 4) Cleaning rod extension;
- 5) Cleaning rod handle;
- 6) 25 ml SENT CLP E oil;
- 7) Allen key.



CLEANING THE BARREL (FIG. 27)

1. Use a brush with a rod that is long enough to clean the barrel from the chamber side.
2. Carefully clean the feeding ramp of the barrel

⚠ WARNING: Do not clean the barrel with the pistol assembled.

⚠ Notice: Cleaning the barrel from the breech (chamber) end will avoid damaging the muzzle or bore.

CLEANING OTHER PARTS

1. Wipe the internal and external metal surfaces with a cloth.
2. Use a small brush to remove debris that has crept into the grooves of the upper and lower receivers.

While cleaning carefully inspect the parts to check for cracks, deformation or signs of wear.

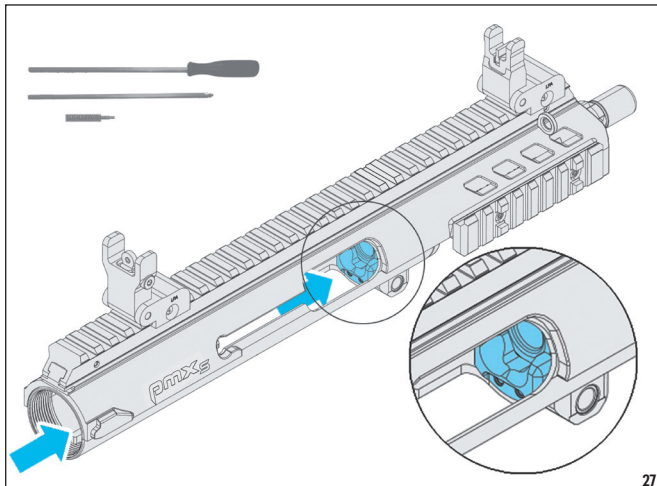

LUBRICATION

1. Lightly oil the outside of the bolt.

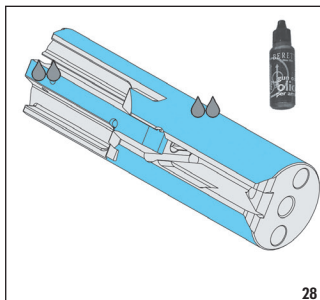

2. Lightly oil the lower ribs of the bolt.
3. Lightly oil the two recoil springs.

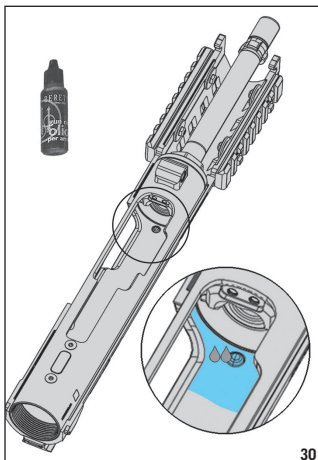
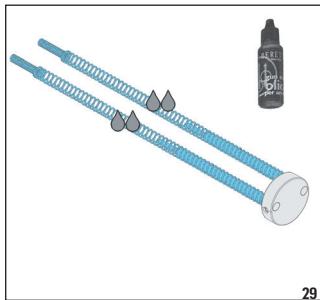

4. Lightly oil the front and inside of the upper receiver.

⚠ CAUTION: Do not apply excess oil. Accumulation of oil attracts dirt and dust, which can interfere with the functioning and reliability of the fire-arm.

BERETTA IRON SIGHTS

⚠ Notice: Beretta Iron Sights are optional to be purchased separately.

To install and adjust Beretta sights (2), use the Allen key provided with the sights.

INSTALLATION AND REMOVAL

⚠ WARNING: Make sure the pistol is unloaded. If not, unload it following the “UNLOADING” instructions in this manual (page 17).

To install the rear sight, loosen screw (1) using the provided Allen key and fit the rear sight onto the guide (3) to the required groove. Tighten the screw to secure it.

To remove the rear sight, loosen the screw (1).

To install the front sight, loosen screw (1) using the provided Allen key and fit the front sight onto the guide (3) to the required groove. Tighten the screw to secure it.

To remove the front sight, loosen the screw (1).

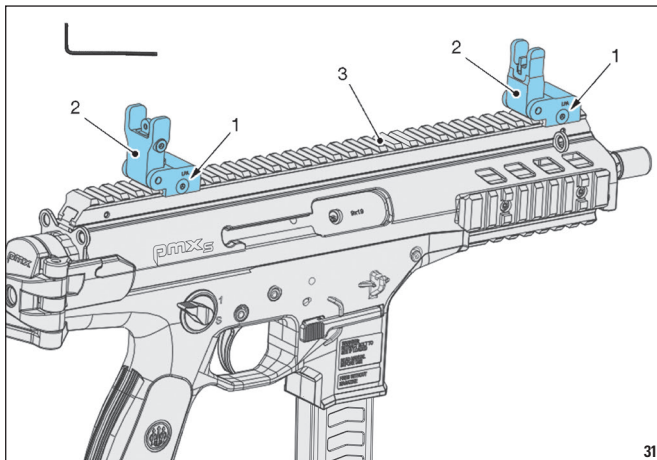

FOLDING AND UNFOLD THE SIGHTS (FIG. 33)

To fold and unfold the front and rear sight, hold and turn them to the required position, until they click into place. When sights are folded, back-up sights are available for use.

AIMING

Center the target in the rear sight aperture and align the top surface of the front sight to the center of the rear sight and the target.

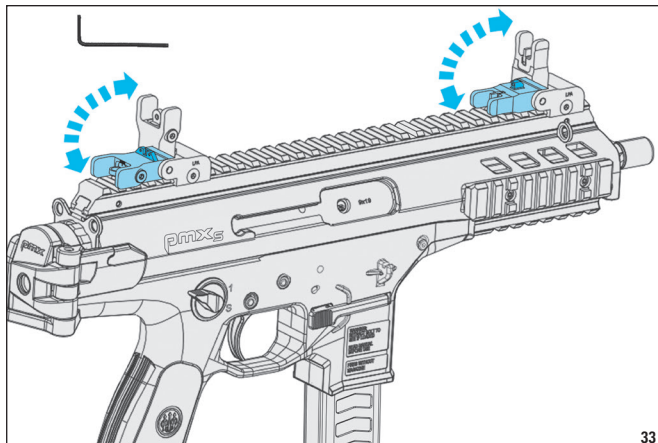
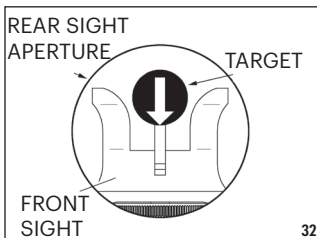

ADJUSTING THE FRONT SIGHT IN ELEVATION

To adjust elevation, use the key provided and turn the elevation screw:

- **counterclockwise** to lower the impact point;
- **clockwise** to raise the impact point.

Adjustment takes place in clicks of 1.2 MOA (0.36 mils) at a time, which corresponds to 9mm at 25m.

Adjustment range is 45 clicks, equal to approximately 400mm at 25m.

ADJUSTING THE REAR SIGHT IN WINDAGE

To adjust windage, use the Allen key provided and turn the windage screw:

- **clockwise** to move the impact point to the right.
- **counterclockwise** to move the impact point to the left.

Adjustment takes place in clicks of 0.4 MOA (0.12 mils) at a time, which corresponds to 3mm at 25m.

Adjustment range is 120 clicks, equal to approximately 360 mm at 25m.

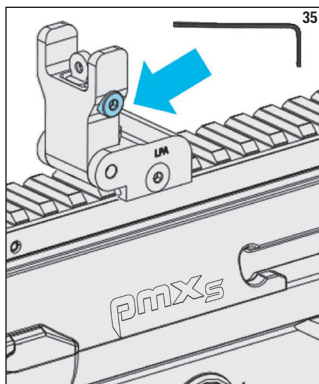
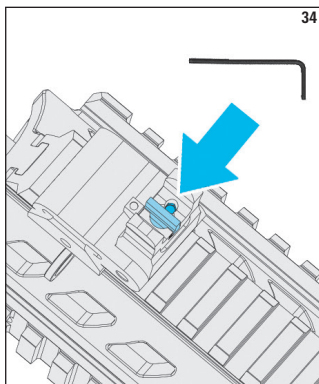

ZEROING PROCEDURE

⚠ WARNING: Make sure the pistol is unloaded. If not, unload it following the “UNLOADING” instructions in this manual (page 17).

To zero the weapon, proceed as follows:

1. Place a target at 25 m, aim and fire three rounds.
2. Check to see where the group center is located relative to the aim point.
3. Calculate the number of clicks required to correct and the direction for turning the elevation screw of the front sight and the windage of the rear sight.
4. Adjust and fire three rounds.
5. Check to see where the group center is located relative to the aim point and make any further adjustments.

STORAGE

⚠ WARNING: Always store the pistol UNLOADED, with the magazine empty.

⚠ WARNING: Always store your firearm so that children can not gain access to it. To reduce the risk of accidents involving children, unload your firearm, lock it and store the ammunition in a separate locked location.

⚠ CAUTION: Before storage, always check the conditions of the pistol and its case. Make sure the case is dry and that the firearm is dry and oiled. Traces of moisture or drops of water could damage the pistol.

TROUBLESHOOTING

⚠ WARNING: Do not attempt to make repairs to any firearm without proper knowledge or training. Do not alter parts or use substitute parts not made by Beretta. Any necessary alterations or adjustments to the operating mechanism should be performed by the Manufacturer or by its Local Official Distributor.

⚠ WARNING: Do not attempt to alter the internal parts of your pistol's firing mechanism. Altering internal parts can cause an unsafe condition.

⚠ WARNING: Altering the internal parts of your pistol's firing mechanism voids the manufacturer's warranty.

If your PMXs pistol stops firing, do the following immediately:

1. Check that the magazine is correctly inserted.

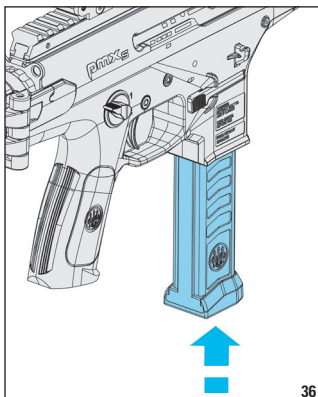

2. Retract the bolt. Observe the ejection of the spent case or the cartridge. Check that the chamber is empty.

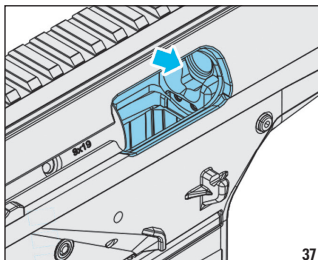

3. If the spent case or the cartridge have been ejected and the chamber is empty, release the cocking handle to feed a new round.
 4. Now fire. If the weapon does not fire, look for the trouble and apply troubleshooting actions.
- If your PMXs stops firing with a live round or a spent case jammed between the bolt and the barrel, as shown in the figure below, do the following immediately:
1. Remove the magazine.
 2. Retract the bolt with the gun pointing in a safe direction and turn it on its side. The live round or the spent case should fall out of the weapon. Ensure that the chamber is empty.
 3. Release the bolt handle.
 4. Insert the magazine and feed a new round.
 5. Fire.
 6. If the jam comes again, look for the trouble and apply troubleshooting actions.

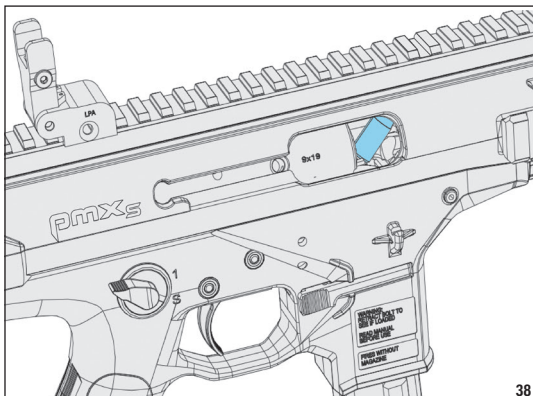

MALFUNCTION	PROBABLE CAUSE	CORRECTIVE ACTION
Failure to feed	<p>Ammunition dirty or corroded</p> <p>Dirty magazine</p> <p>Broken magazine</p> <p>Magazine not fully inserted</p> <p>Dirty Weapon</p> <p>Recoil spring force too low</p>	<p>Clean</p> <p>Clean</p> <p>Replace</p> <p>Remove the magazine and reinsert it</p> <p>Disassemble the weapon and clean</p> <p>Remove and clean the recoil spring guide group If the problem continues, replace the recoil spring guide group or both the springs</p>
Failure to extract	<p>Broken cartridge case in the chamber</p> <p>Dirty extractor</p> <p>Broken extractor parts</p>	<p>Let a properly trained gunsmith remove the cartridge case</p> <p>Clean and lubricate the parts of the extractor</p> <p>Let a properly trained gunsmith replace broken parts</p>

MALFUNCTION	PROBABLE CAUSE	CORRECTIVE ACTION
Failure to chamber	Firing residue in the chamber Ammunition dirty or corroded Damaged ammunition	Inspect the barrel for any obstructions and remove any firing residue Replace Replace
Failure to eject	Recoil too fast Short recoil too slow Low pressure ammunition	Clean the bolt group to remove any excess lubricant If the problem continues, let a properly trained gunsmith replace the recoil spring guide group Clean the bolt Clean and lubricate the weapon

MALFUNCTION	PROBABLE CAUSE	CORRECTIVE ACTION
Failure of the bolt to remain open	Magazine deformed	Replace the magazine
	Low pressure ammunition	Clean and lubricate the weapon
	Short recoil	Clean the bolt
	Recoil too fast	Clean the bolt group to remove any excess lubricant If the problem continues, let a properly trained gunsmith to replace the recoil spring guide group
	Bolt catch damaged	Let a properly trained gunsmith replace the bolt catch
Lower receiver damaged	Let a properly trained gunsmith replace broken parts	

MALFUNCTION	PROBABLE CAUSE	CORRECTIVE ACTION
Failure to fire	Faulty ammunition	Remove and dispose
	Chamber empty	Position the fire selector to "S" and check that there is a cartridge in the chamber
	Fire selector positioned on "S"	Turn the fire selector to "1"
	Bolt is not completely in battery	Clean the chamber, clean the bolt group
	Firing pin broken	Let a properly trained gunsmith replace broken parts
	Broken or damaged hammer springs	Let a properly trained gunsmith replace broken parts
	Incorrect assembly of the hammer springs Hammer notch broken Part of the trigger mechanism broken	

SERIAL NUMBER:

DATE PURCHASED:

PURCHASE PRICE:

DEALER information:

The illustrations and descriptions given in this brochure are intended as a general guide only, and must not be taken as binding. The Company, therefore, reserves the right to make, at any moment and without prior notice, any changes it thinks necessary to improve its models or to meet any requirements of manufacturing or commercial nature.

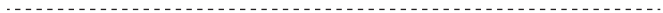
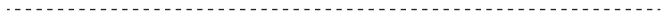

PMXs
PISTOL
USER MANUAL

PMXs

PISTOL - USER MANUAL



BERETTA

FABBRICA D'ARMI P. BERETTA S.P.A.

VIA PIETRO BERETTA, 18

I 25063 GARDONE VAL TROMPIA, BRESCIA, ITALY

BERETTA.COM

C6C544 003